

INDUSTRIAL FOR LEASE

AVAIL SF: 4,827

TOTAL BLDG SF: 48,176



ADDRESS 14613-14635 CARMENITA RD UNIT 14633, NORWALK CA ZIP 90650

Carmenita Business Center - No CAMs North Of S.A. (5) Fwy On Carmenita Main Street Frontage/Rear Loading Door

LEASE RENTAL \$ 1,665 /mo Gross 0.345 Net _____ Term ACCEPTABLE TO OWNER
 SALE PRICE \$ NFS Price/SF \$ _____ Tax \$ 1,928.00 Yr 2009-2010
 Terms _____ Possession Immediate
 Avail SF 4,827 Dim IRR X IRR Power A 200 V 120-208 Ø 3 W 4
 Min. SF 4,827 Dim IRR X IRR Lighting VERIFY Heat VERIFY Cooling VERIFY PWR Notes VERIFY
 Land SF POL Dim IRR X IRR Trk Hi Pos 0 Dim _____
 Const CTU Roof VERIFY Grd Lev Drs 2 Dim 10x12 Well N
 Rail NONE Unfin Ofc Mezz SF TBD Incl in Avail SF N Rest Rms: M TBD W TBD
 Sprkd NO Min Clr Hgt 15 OFFICE DATA Ofc SF 250 # 3 Rest Rms: M TBD W TBD
 Pkg 10 Yard No Yr Blt 1972 A/C TBD Heat TBD Fin Ofc Mezz SF TBD Incl in Avail SF N
 Thomas Bk Pg# 737-C3 Zone M1 To Show Call Broker - FOR APPOINTMENT Sp. Feat. PARK
 AGENT Douglas E Wells (562)908-6012 x203, Steven K Naylor Region SE Listing # 1212765
(562)908-6015, Justin Wells (562)908-6016 x 205 FIRM Penta Pacific Properties 04/10/09
 FTFC CB250N000S000/AOAA Notes Lock Box - JX206 On Front Door. Lease Term: 2-5 Years W/Annual CPI. Base rental rate is valid only for the first 6 months of the Lease with approved credit on a minimum 2-year term. Rate thereafter is \$.69/SF.

THIS IS A LISTING OF THE "MULTIPLE" AND IS SUBJECT TO ALL ITS APPLICABLE RULES AND REGULATIONS

This information has been furnished from sources which we deem reliable, but for which we assume no liability. The information contained herein is given in confidence, with the understanding that all negotiations pertaining to this property be handled through the submitting office. All measurements are approximate.
 © American Industrial Real Estate Association



CARMENITA BUSINESS CENTER

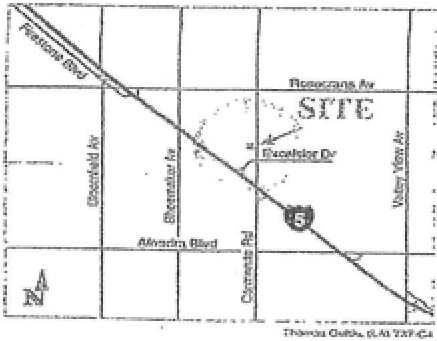

For further information call:

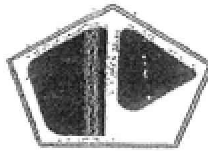

Doug Wells
(562) 908-6012

PENTA PACIFIC PROPERTIES
9500 Norwalk Boulevard
Santa Fe Springs, CA 90670

Subject

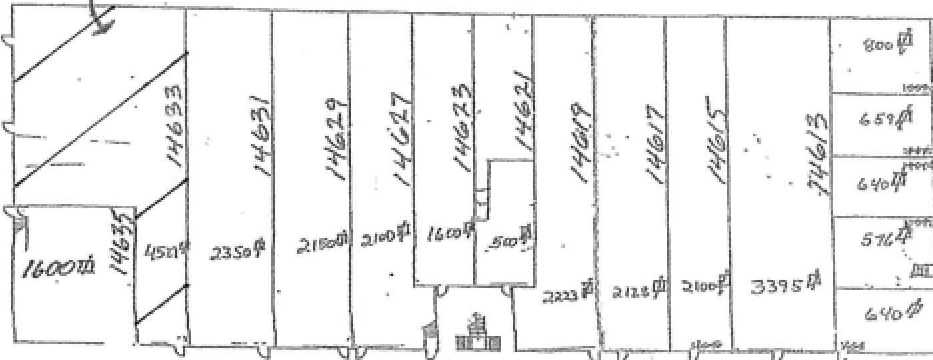

← CARMENITA ROAD →